

BOSSVENT

INSTALLATION GUIDE



Nissan Navara (2015-ON NP300 D23 ST 2.3L) Oil Catch Can Kit

KIT COMPONENTS:

<p>1. BOSSVENT XL</p> 	<p>2. OUTLET HOSE</p> 	<p>3. INLET HOSE</p> 
<p>4. MOUNTING BRACKET</p> 	<p>5. OIL DRAIN KIT</p> 	<p>6. HARNESS KIT</p> 
<p>7. FASTENER KIT</p> 	<p>8. CABIN SWITCH</p> 	



Nissan Navara (2015-ON NP300 D23 ST 2.3L) Oil Catch Can Kit

STEP 1

WARNING: Ensure engine is off and cool enough to work on!

Identify install area (passenger side of engine bay).

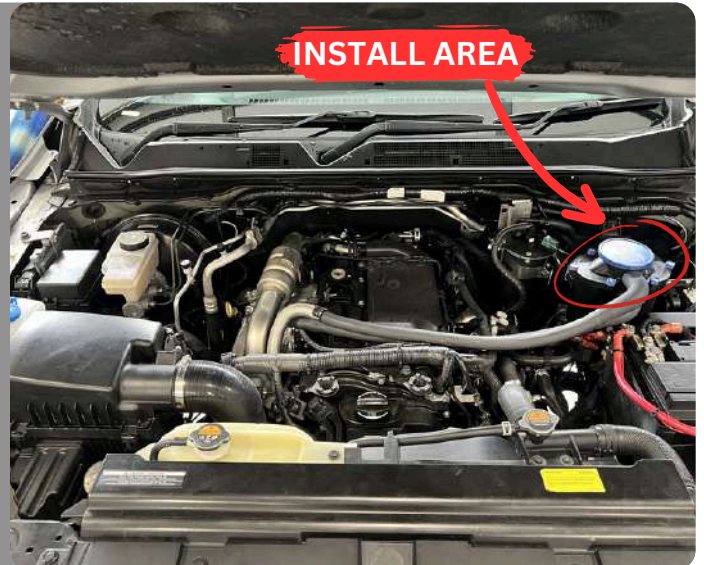

STEP 2

Locate mounting points on the passenger side of the engine bay



STEP 3

Install BOSSVENT bracket to the mounting location using the supplied fasteners



Nissan Navara (2015-ON NP300 D23 ST 2.3L)
Oil Catch Can Kit

STEP 4

Attach oil drain tube to BossVent drain port, firmly push tube into place and tighten nut. Feed the the oil drain tube down the passenger side wheel arch.



STEP 5

Attach BossVent to bracket using 2x M8 bolts and spring washers provided.



STEP 6

Install INLET and OUTLET hoses to the BossVent.

IMPORTANT:
Match IN to IN hose and OUT to OUT hose locations as shown.

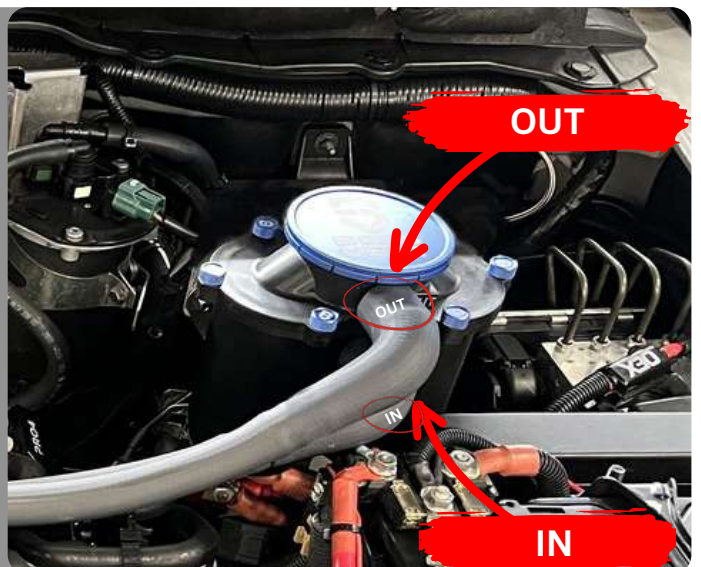



Nissan Navara (2015-ON NP300 D23 ST 2.3L) Oil Catch Can Kit

STEP 7

Remove the crankcase breather hose where shown

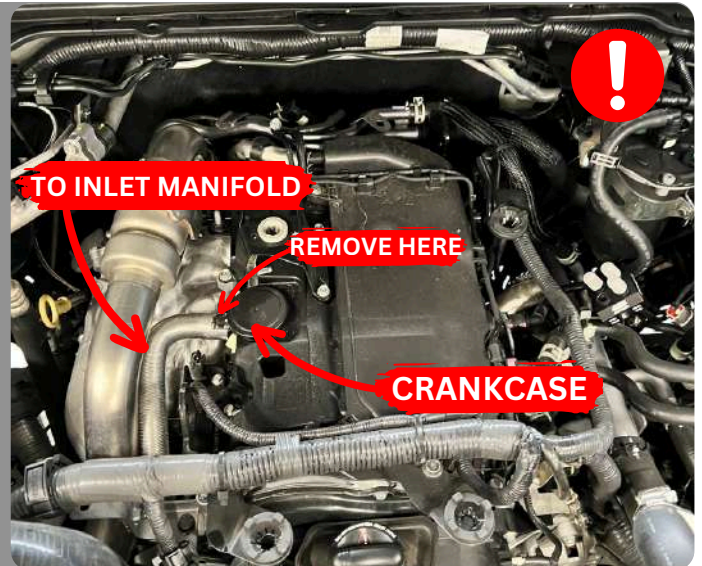

STEP 8



Connect hoses as shown

- OUT connection on Catch Can to INLET MANIFOLD
- IN connection on Catch Can to CRANKCASE

Tighten all hose clamps and secure hoses with Zip ties.

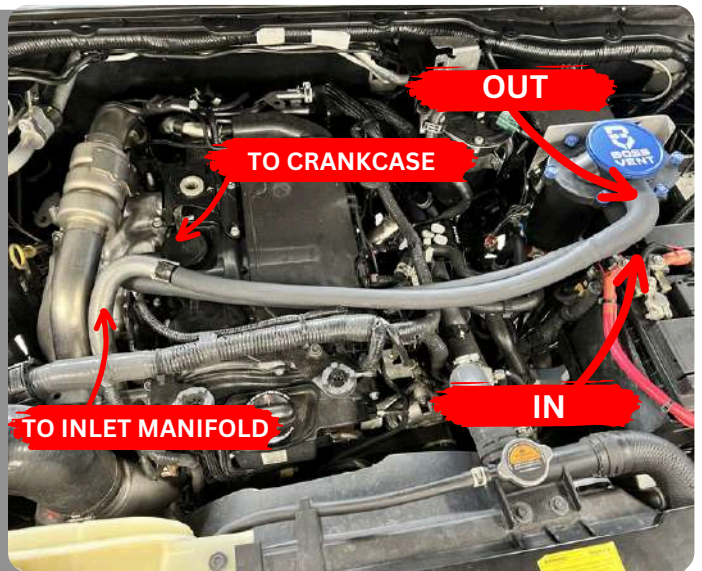

STEP 9

Guide the drain tube past the engine on the passenger side to the rear of the front left wheel arch for bracket installation.



**Nissan Navara (2015-ON NP300 D23 ST 2.3L)
Oil Catch Can Kit**

STEP 10A

Trim tube to length using cutter provided.



STEP 10B

Push clear tubing firmly onto BossVent drain tap tap. Ensure the tap is turned off as shown.



STEP 10C

Insert dust plug into end of tap.





Nissan Navara (2015-ON NP300 D23 ST 2.3L) Oil Catch Can Kit

STEP 10D

Using zip ties provided secure drain tap and drain hose to chassis rails or similar ensuring the tap and hose are out of the way of the wheels and moving suspension components



STEP 11 - DRAINING

Pull back locking collar and withdraw dust plug before draining the catch can.

Turn tap through 90 degrees to drain.
Return tap to the position shown above and replace dust plug after draining.

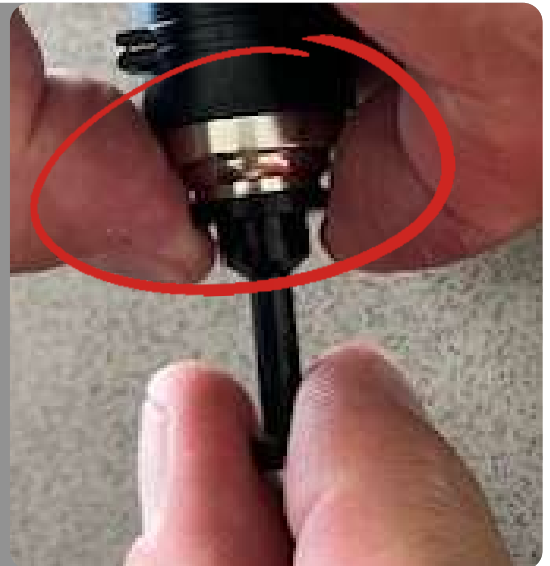

STEP 12

Route the wiring harness from the BossVent catch can to the passenger's side where the grommet is located.

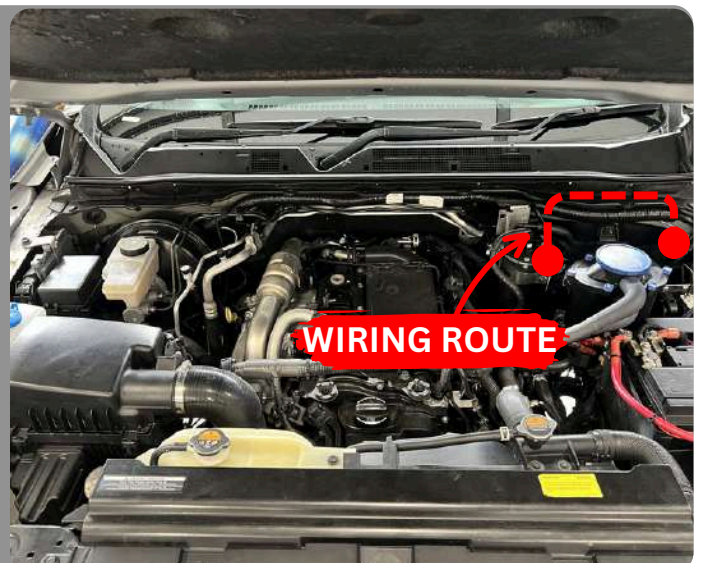



Nissan Navara (2015-ON NP300 D23 ST 2.3L) Oil Catch Can Kit

STEP 13

From the engine bay passenger's side, pass the small plug and spade terminals through the firewall grommet to the passenger's side footwell.

Using a stiff wire taped to the cables will help here



STEP 14

Pull cable through grommet and connect engine bay side plug into the BossVent plug as shown.



STEP 15

Route wiring harness under dash to drivers side around the steering column area and zip tie harness into place.





**Nissan Navara (2015-ON NP300 D23 ST 2.3L)
Oil Catch Can Kit**

STEP 16

Remove panels to access the cigarette lighter / accessory power (ensure this power turns off when the car is turned off).



STEP 17A

If using the T tap connectors provided, open T tap connector end as shown.



STEP 17B

Locate suitable electrical cable and close T tap connector end over cable firmly until it locks into place using pliers or similar as shown.

Note:

Negative (-) to ground and Positive 12V (+) to accessory or ignition power





**Nissan Navara (2015-ON NP300 D23 ST 2.3L)
Oil Catch Can Kit**

STEP 17C

If using the T tap connector and not using spade terminals for connection then cut off the female spade terminal end and strip approximately 10mm of the outer sheath from the cable as shown

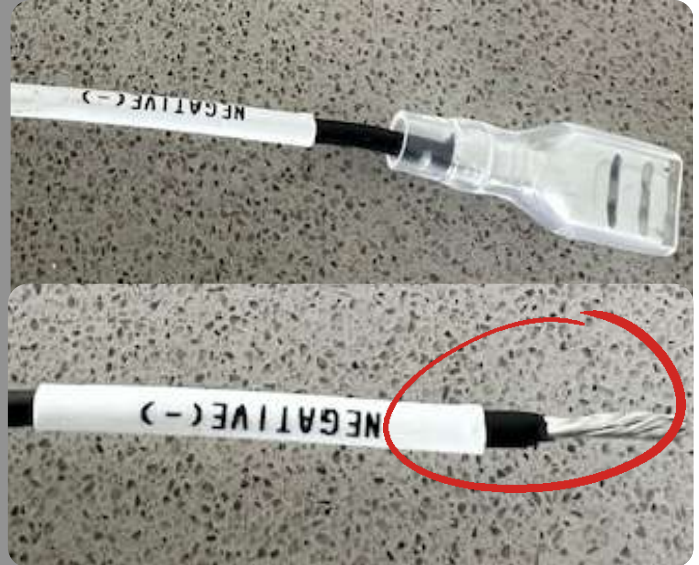

STEP 17D

Open lever on T tap connector and insert cable approximately 10-12mm as shown

Close lever and check cable is firmly secured

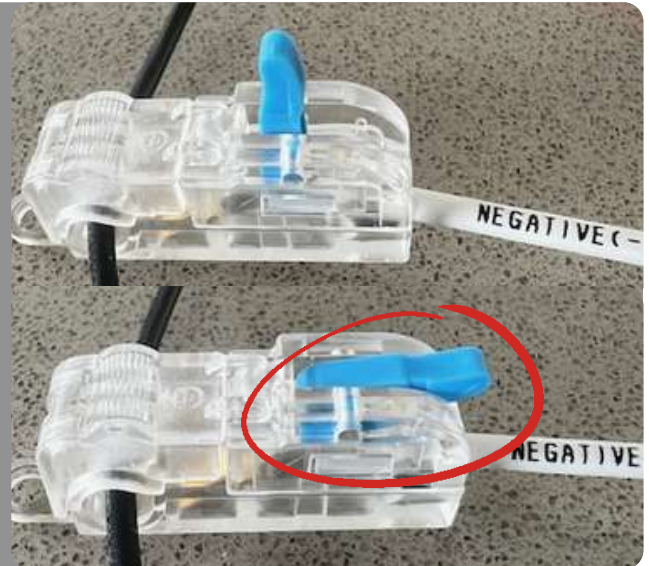

STEP 18

Identify a suitable location to place the BOSSVENT surface mount switch so that it's always visible from the driving position.





Nissan Navara (2015-ON NP300 D23 ST 2.3L) Oil Catch Can Kit

STEP 19

Wipe dash surface to ensure a clean area to fit the surface mount switch

Plug switch wiring in & route in a suitable location from behind the dash

Peel off adhesive backing and fit switch to dash



STEP 20

Start the engine and inspect for leaks or loose ends.

HOSES MUST HAVE NO KINKS OR OBSTRUCTIONS.



YOU'RE GOOD TO GO, MATE!





BOSSVENT

IN-CABIN INDICATOR LIGHT STATUS

ONLINE VERSION



IGNITION TURNED ON

Light will flash twice

Status: Your catch can is being continuously monitored



NO LIGHT FLASH

Status: No maintenance required



1 FLASH PER SECOND

Status: Drain oil required!



2 FLASHES PER SECOND

Status: Replace filter elements required!



 INFO@BOSSVENT.COM

 1800 935 936

BV205-LM-001A



DRAIN OIL

Remove the red oil dust cap and open the tap.

Let the oil drain from your catch can.

Close the tap when oil stops and make sure you place the dust cap back once you finished.

[Click here for video instructions.](#)



REPLACE FILTERS

Open the catch can, twisting all 6 thumbs screws.

Clean the sensor with some cloth.

Lubricate the new filters o-rings with some oil before inserting.

Changing the filter is easy. No tools are required!

YOU'RE GOOD TO GO, MATE!

